

SECTOR-19 PH.-II

ROAD 60.0M. W I D E

COMM.CENTER

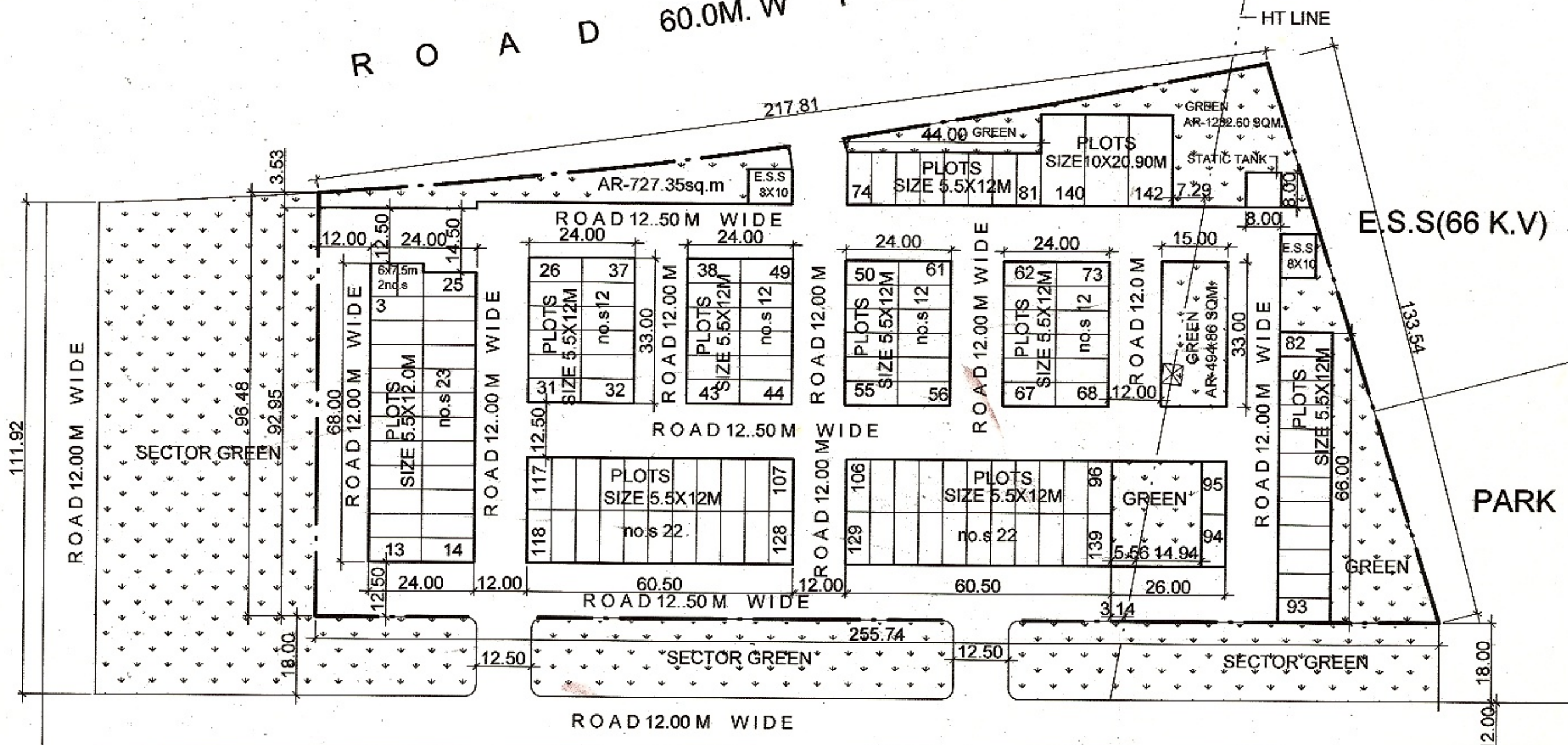

POCKET 9

THE REVISED L.O.P. IS APPROVED IN THE 270th SCREENING COMMITTEE MEETING HELD ON 24.10.08 VIDE ITEM NO 167:2008.IN FILE NO. F1 (76) PLG /DWK/07/PT-II.

THE LAYOUT PLAN FOR THE PLOTTED DEVELOPMENT WAS APPROVED SUBJECT TO ;

LAND DISPOSAL WING WILL DECIDE ABOUT THE MODE OF ALLOTMENT BY AUCTION / ALLOTMENT OF PLOTS LOCATED ON 100.0M/ 60.0M ROAD WITH THE APPROVAL OF THE COMPETENT AUTHORITY. IT WAS ALSO DECIDED THAT THE EQUIVALENT NO. OF PLOTS WHICH MAY BE UTILIZED FOR AUCTION MODE BE CARVED OUT ELSEWHERE FOR ALTERNATIVE PLOT ALLOTMENT .

D . D . A .

DWARKA PROJECT

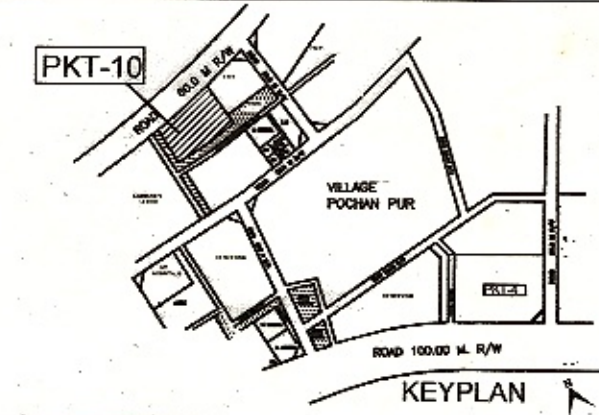

AREA STATEMENT

TOTAL AREA OF POCKET = 2.55 HAC.

AREA UNDER PLOTS	= 9759.00 SQM.	38.27%
AREA UNDER RECREATIONAL	= 4081.85 SQM.	16.01%
AREA UNDER CIRCULATION	= 11435.15 SQM.	44.84%
AREA UNDER UTILITY	= 224.00 SQM	0.88%

PLOT DETAILS

NO. OF PLOTS	SIZE	AREA IN sq. m	AREA IN sq yds	PLOT NO.S
002	6.00m x 7.5m	45.00	53.83	1 TO 2
137	5.50m x 12.0m	66.00	80	3 TO 139
003	10.0 m x 20.90m	209.0	250	140 TO 142

E.S.S - 2 NOS

NOTES

- 1- THE PLAN ARE BASED ON TOTAL STATION SURVEY SUBMITTED BY EX. EN. WD -12 VIDE LETTER NO.DB/128/AE(P)/WD- 12 /DDA/ 49 DATED 16.6 07 .
- 2- THE LAYOUT PLAN WAS APPROVED BY SCREENING COMMITTEE VIDE ITEM NO. 75:208 DATED 2-5-08.
- 3- THE LAYOUT PLAN MODIFIED ON THE BASIS OF FEASIBILITY REPORT OF EX. EN. WD -12 VIDE LETTER NO. DB/128/AE(P) WD-12/DDA/1366 DATED 17-9-08.
- 4- ALL GREEN TO BE MAINTAIN BY HORT.DEPTT.

REVISED LAYOUT PLAN OF ALTERNATIVE PLOTS FOR RESIDENTIAL POCKET-10 SEC. 23 PH II

SCALE : 1: 1000	DWK/SEC-23/PH-II/AL-10/PKT-10/09157	DRG. NO.	DATE	SEPT. -2008
B. N. SHARMA PLG. D/MAN (PLG.)	RITA SEHGAL S.P KAUR PLG. ASSTT. (PLG.)			
N.R.ARAVIND ASSTT. DIR. (PLG.)	TAPAN K. MONDAL JT. DIRECTOR (PLG.)			

DELHI DEVELOPMENT AUTHORITY